

SLIDE THE CAPS INTO THE ENDS OF THE TRACK (UNLESS CAPS ARE ALREADY INSERTED)

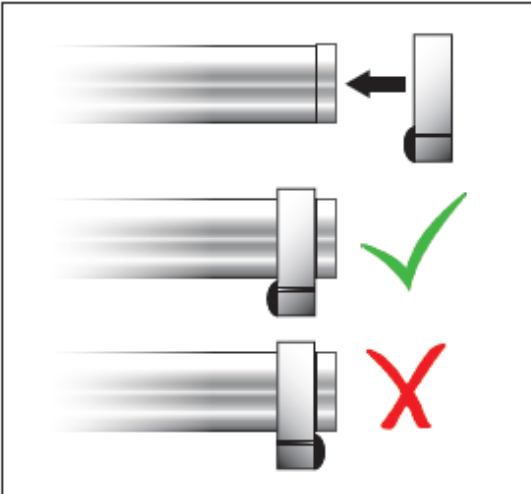

SLIDE THE STOPPERS ONTO EACH END OF THE TRACK

MAKE SURE THAT THE RUBBER BUMPERS ARE FACING TOWARD THE CENTER OF THE TRACK AND NOT FACING TOWARDS THE OUTSIDE

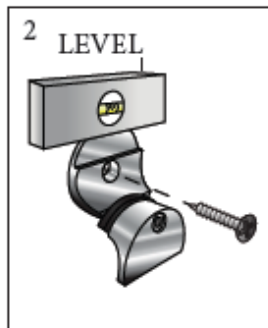
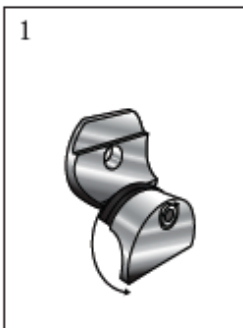

1 - DISASSEMBLE THE WALLBRACKET AND ATTACH THE BACK HALF OF THE BRACKET AND GASKET TO THE WALL.

2 - **IMPORTANT:** THE WALL MOUNTING BRACKETS MUST BE LINED UP AND PERFECTLY LEVEL. IF THE BRACKETS ARE NOT 100% LEVEL, THE MOVEMENT OF THE DOORS WILL BE AFFECTED

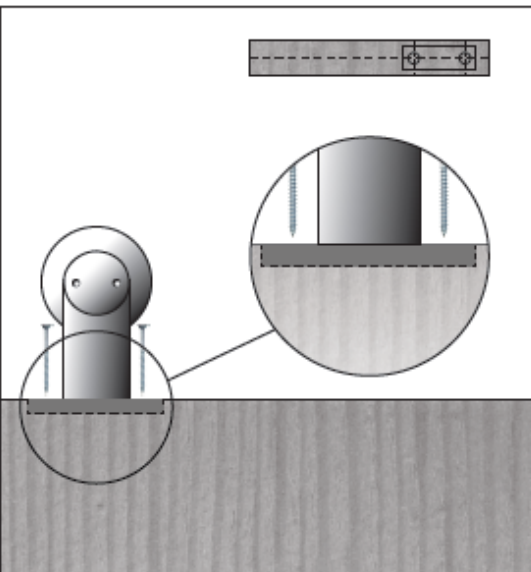

MAKE SURE TO DRILL THE PILOT HOLES CENTERED TO THE THICKNESS OF THE TOP OF THE DOOR

THE WHEEL ASSEMBLY MUST BE MOUNTED FLUSH INTO THE TOP OF THE DOOR.

MORTISE OUT THE TOP OF THE DOOR SO THAT THE PLATE OF THE WHEEL ASSEMBLY IS NOW FLUSH WITH THE TOP OF THE DOOR. THIS WILL ENSURE THAT THE ANTI-JUMP FUNCTION WILL WORK CORRECTLY

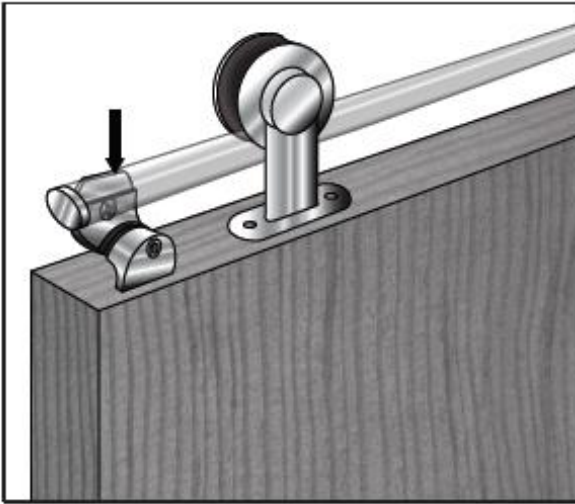

WITH THE WHEEL ASSEMBLY SCREWED IN TO THE TOP OF THE DOOR, TAKE THE TRACK AND PUT IT UNDER EACH WHEEL. THEN TAKE THE DOOR WITH THE TRACK IN PLACE AND SET THE TRACK ON THE WALL MOUNTS

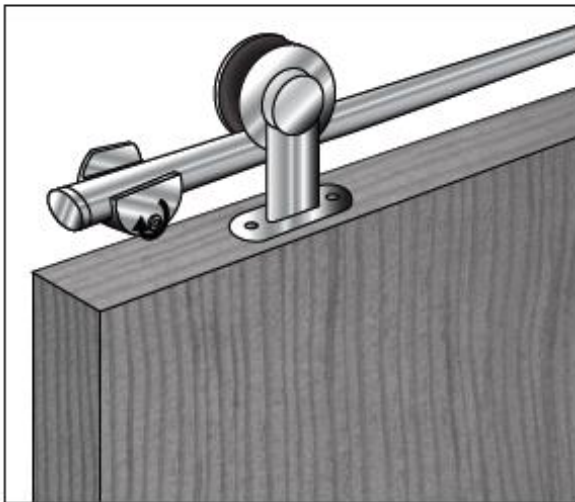

ROTATE THE FRONT OF EACH WALLMOUNT TO CLOSE IT AND THEN TIGHTEN IT. ONCE THE WALL MOUNTS ARE TIGHTENED THE DOOR SHOULD SLIDE WELL FROM SIDE TO SIDE WITH THE ANTI-JUMP ACTIVATED.

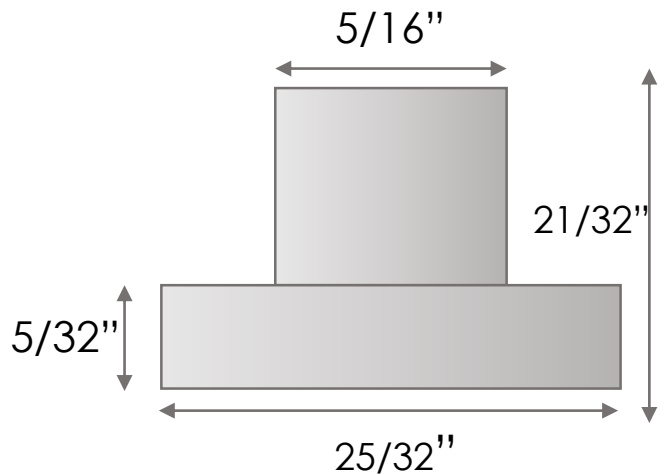
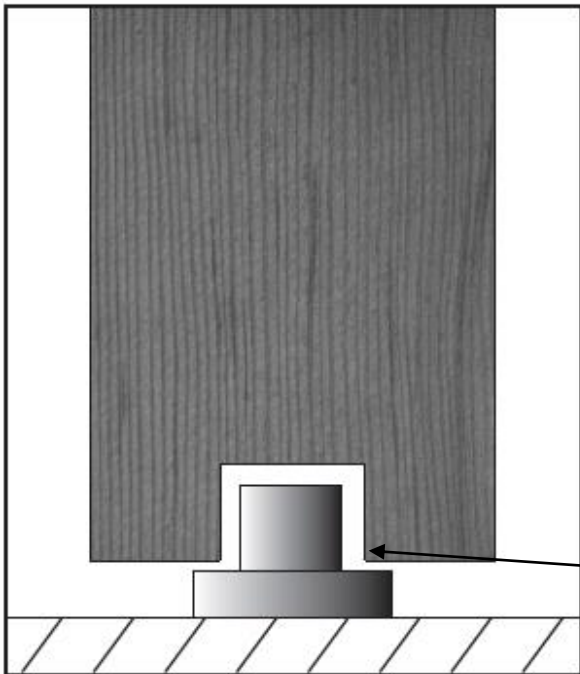

MAKE SURE THAT THE BOTTOM OF THE DOOR HAS A CHANNEL TO ACCEPT THE FLOOR GUIDE

Recommended Opening 3/8"

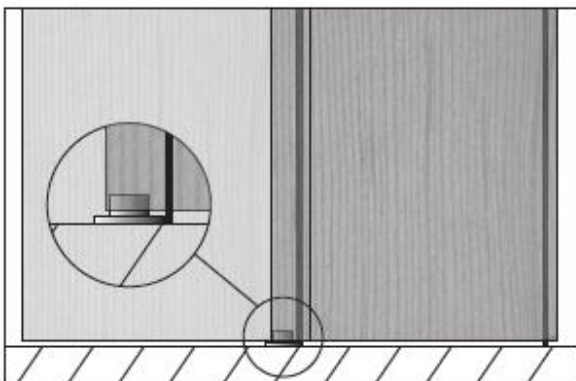

OPEN THE DOOR FULLY. THAT IS THE SIDE THAT THE FLOOR GUIDE WILL BE LOCATED.

LOCATE THE GUIDE AS CLOSE TO THE FRAME AS POSSIBLE TO PREVENT ANYONE FROM STEPPING ON IT.

ADJUST THE STOPPERS SO THAT THE DOOR WILL ALWAYS STAY IN CONTACT WITH THE FLOOR GUIDE. THE DOOR SHOULD NEVER BE ABLE TO LOSE CONTACT WITH THE GUIDE.