

LOCK & STRIKE ASSEMBLY INSTALLATION INSTRUCTIONS

How To Change The Left To Right : (Only Changing The Inside Locks As Shown)

(LEFT HAND SHOWN)

- Please take off the screw on latch and reverse the latch
- Tightening the screw on latch to fix the latch
- Turning the locks 180 degree as shown

Spring Tension Adjustment Screw.

Please adjust only when handle can't return to original position caused by really heavy handle

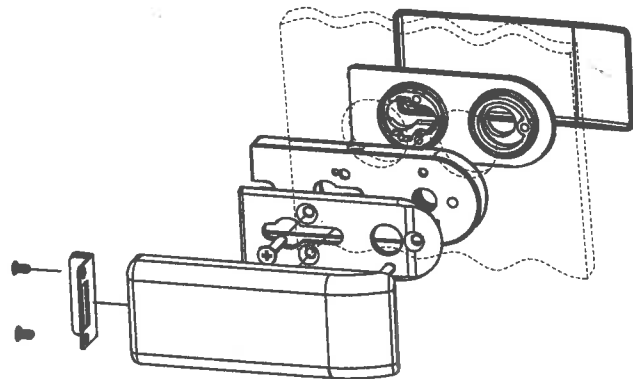
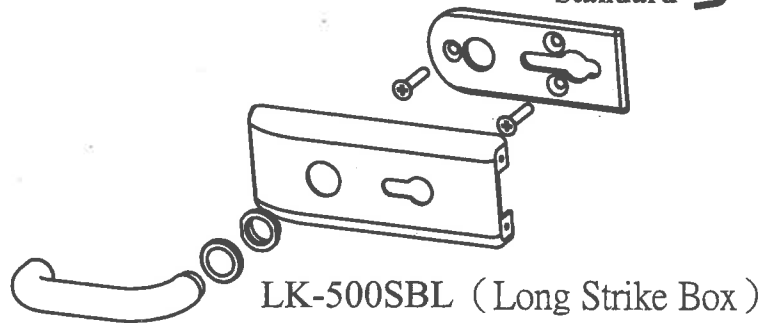
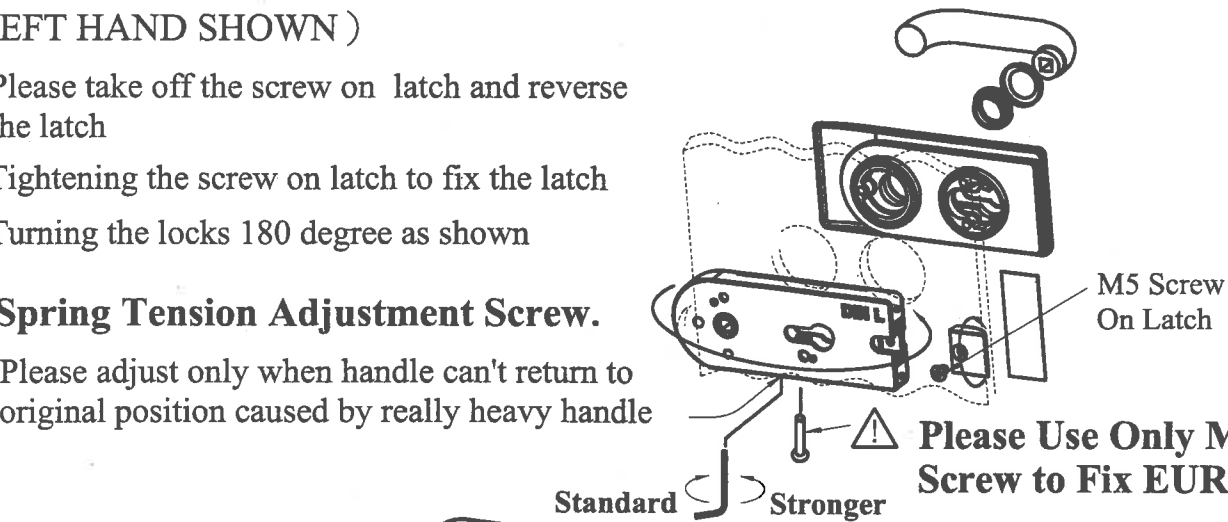

Size of Glass Cutout
w/ Short Strike Box
(LK-500 & LK-500SB)

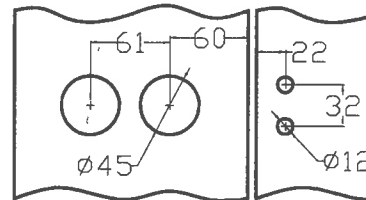

Size of Glass Cutout
w/ Long Strike Box
(LK-500 & LK-500SBL)

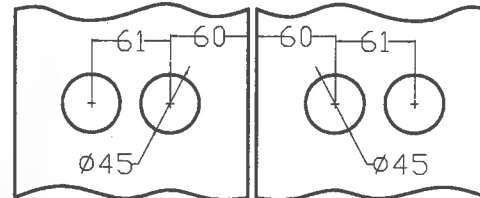

Glass Door To The Frame

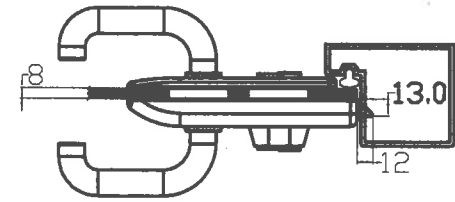

Glass Door To Side Fixed Panel

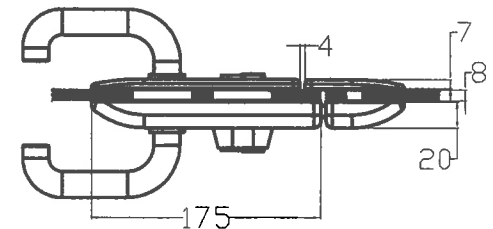
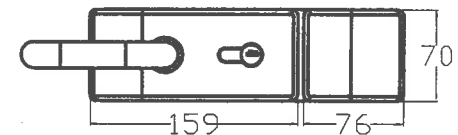

LK-500SB (Short Strike Box)

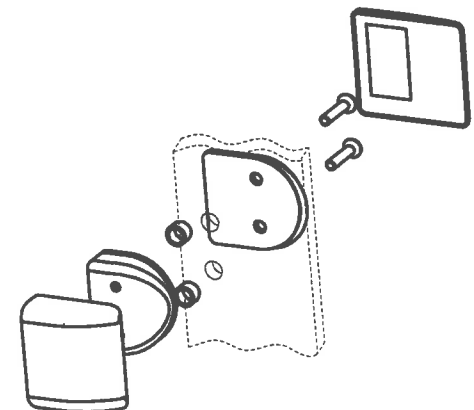

EN 18251-1 : 2002-07 Standard Approved

Passed 200,000 Cycles Test Of Handle And 50,000 Cycles Test For Locking

Patented In Many Countries